

2.WORKMATES SURFACE

A LUMINAIRE INSTALLATION

INSTALACIÓN DE LA LUMINARIA / INSTALLAZIONE DELLA LAMPADA / INSTALLATION DER BELEUCHTUNG / INSTALLATION DU LUMINAIRE / INSTALAÇÃO DO APARELHO DE ILUMINAÇÃO / 照明器具の設置-据付け / 灯具的安装 / МОНТАЖ ОСВЕТИТЕЛЬНОГО ПРИБОРА / ШАМДАЛДЫ ОРНАТУ / تركيب وحدة الإنارة

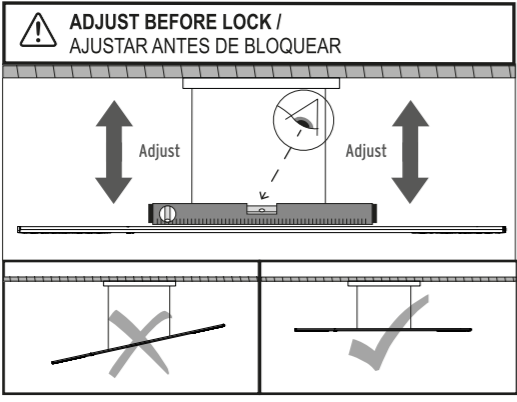
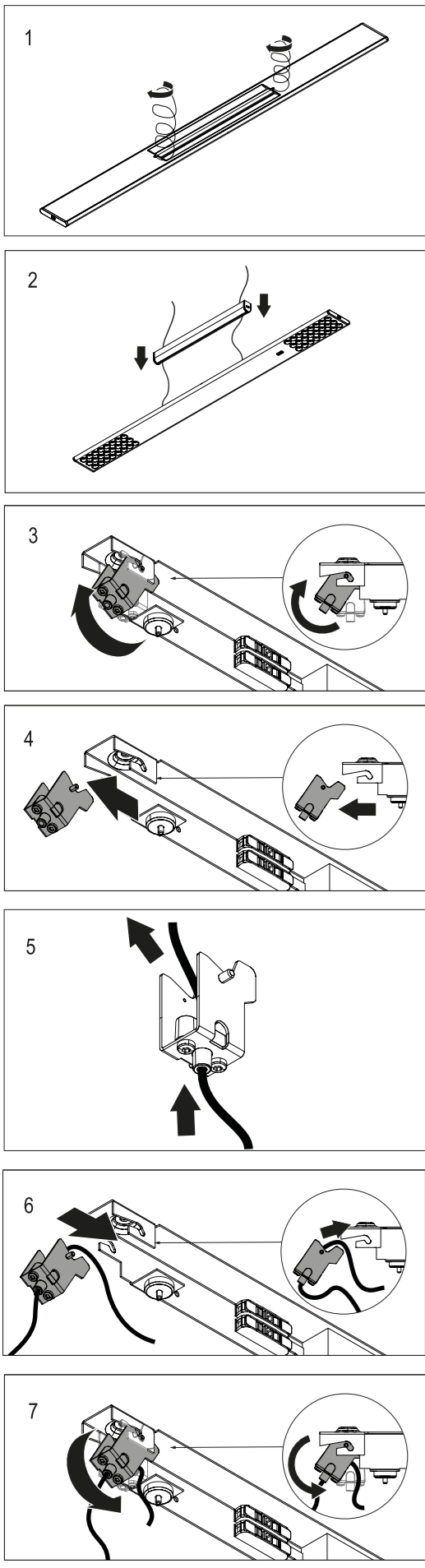

MEASURE BEFORE LOCK AND CUTTING / MEDIR ANTES DE FIJAR Y CORTAR

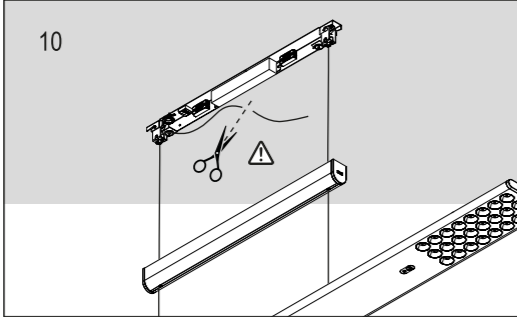
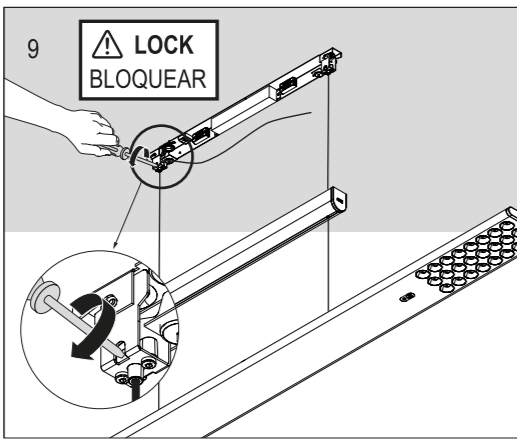
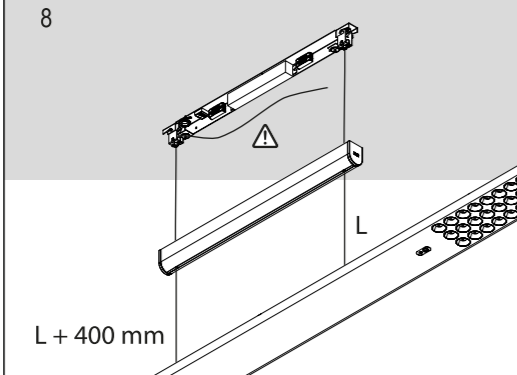

UP&DOWN NO DIM / UP&DOWN DALI

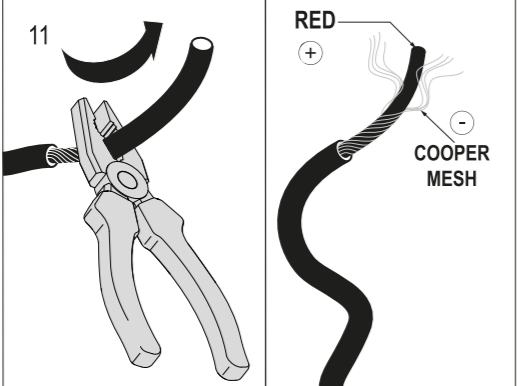

CONNECT DRIVER ACCORDING TO SCHEME / CONECTE EL CONDUCTOR SEGÚN EL ESQUEMA

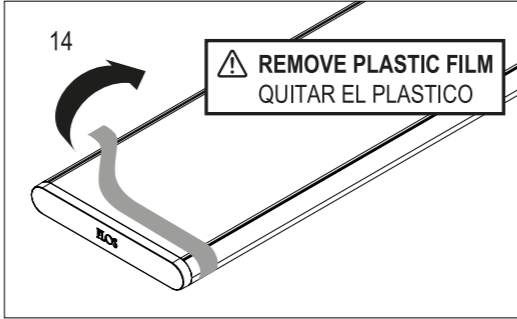
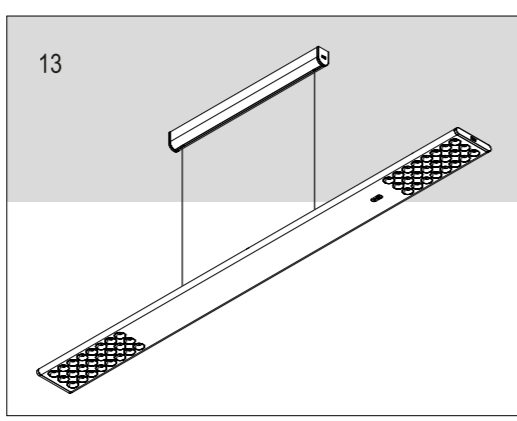
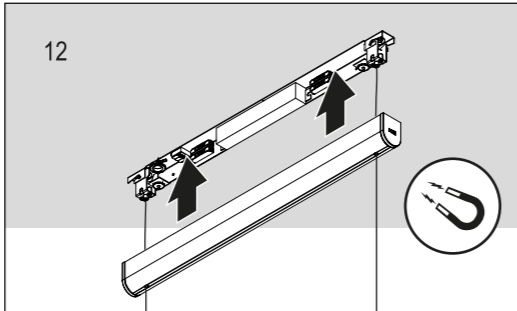

3.WORKMATES REMOTE DRIVER

A TECHNICAL DATA

DATOS TÉCNICOS / DATI TECNICI / TECHNISCHE DATEN / DOWNES TECHNIQUES / DADOS TÉCNICOS / テクニカルデータ / 技術数据 / ТЕХНИЧЕСКИЕ ДАННЫЕ / ТЕХНИКАЛЫЙ МОДУЛМЕТЕР / بيانات تقنية

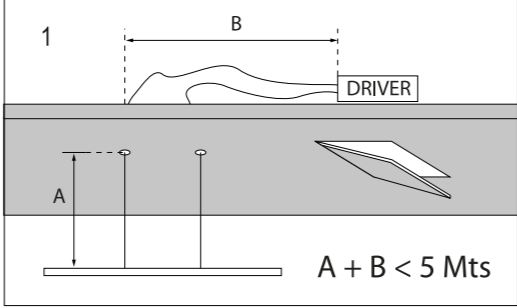

B LUMINAIRE INSTALLATION

INSTALACIÓN DE LA LUMINARIA / INSTALLAZIONE DELLA LAMPADA / INSTALLATION DER BELEUCHTUNG / INSTALLATION DU LUMINAIRE / INSTALAÇÃO DO APARELHO DE ILUMINAÇÃO / 照明器具の設置-据付け / 灯具的安装 / МОНТАЖ ОСВЕТИТЕЛЬНОГО ПРИБОРА / ШАМДАЛДЫ ОРНАТУ / تركيب وحدة الإنارة

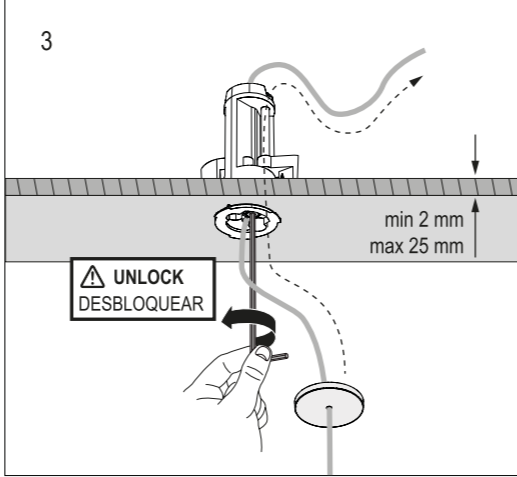
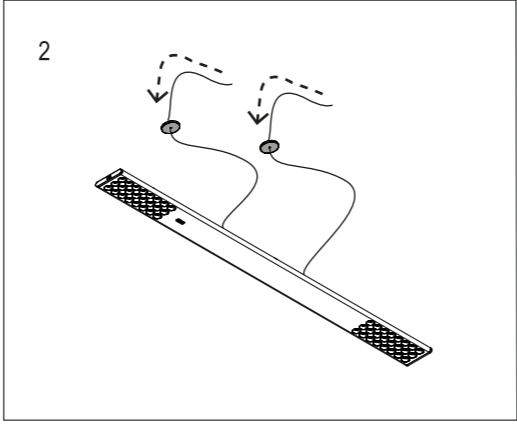
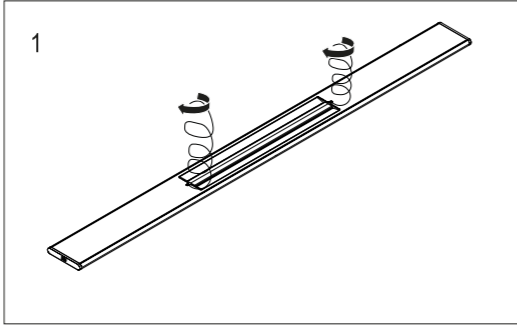

ADJUST BEFORE LOCK / AJUSTAR ANTES DE BLOQUEAR

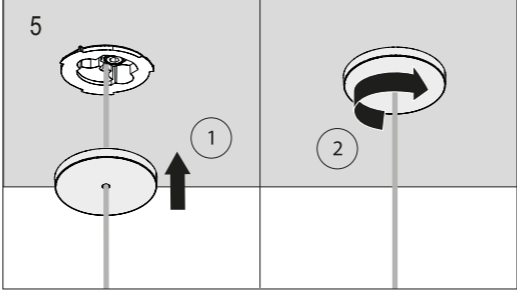
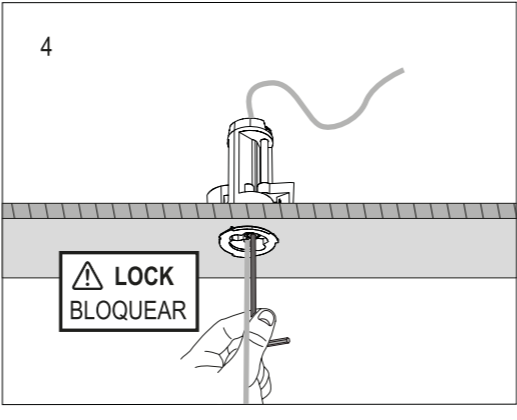
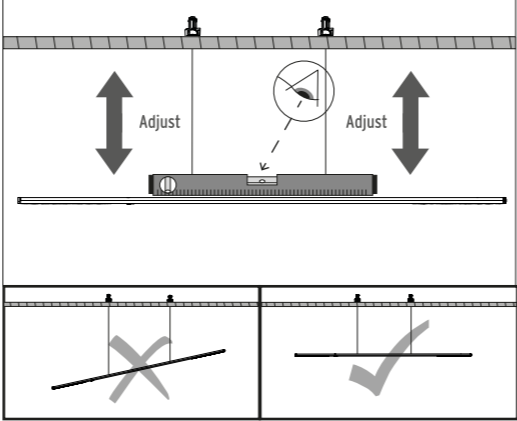

4 ELECTRICAL CONNECTION

CONEXIÓN ELÉCTRICA / CONNESSIONE ELETTRICA / ELEKTRISCHER ANSCHLUSS / CONNEXION ÉLECTRIQUE / LIGAÇÃO ELÉCTRICA / のコネクション / 電力连接 / ЭЛЕКТРИЧЕСКОЕ ПОДКЛЮЧЕНИЕ / ЭЛЕКТРИК БАЙЛАНЫС / التوصل الكهربي

DOWNLIGHT / UP&DOWN CASAMBI

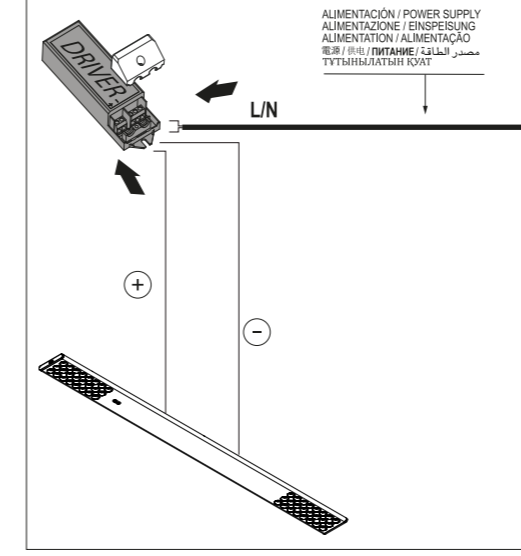

UP&DOWN NO DIM / UP&DOWN DALI

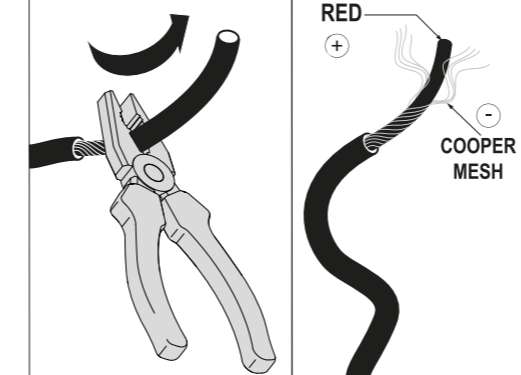

UP&DOWN NO DIM

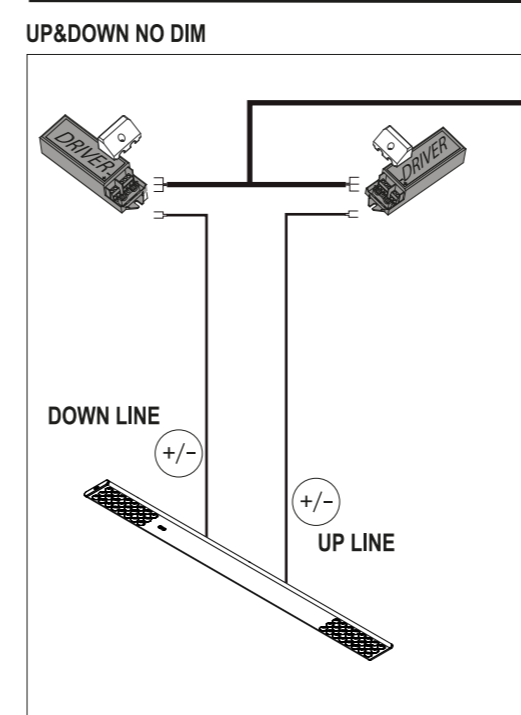

CONNECT UP LINE AND DOWN LINE CABLES TO MAJORITY OR MINORITY DRIVER ACCORDING TO USER PREFERENCE / CONECTE LOS CABLES DE LA LÍNEA ARRIBA Y DE ABAJO A CONDUCTOR MAYORÍA O MINORÍA SEGÚN PREFERENCIA DE USUARIO.

UP&DOWN DALI

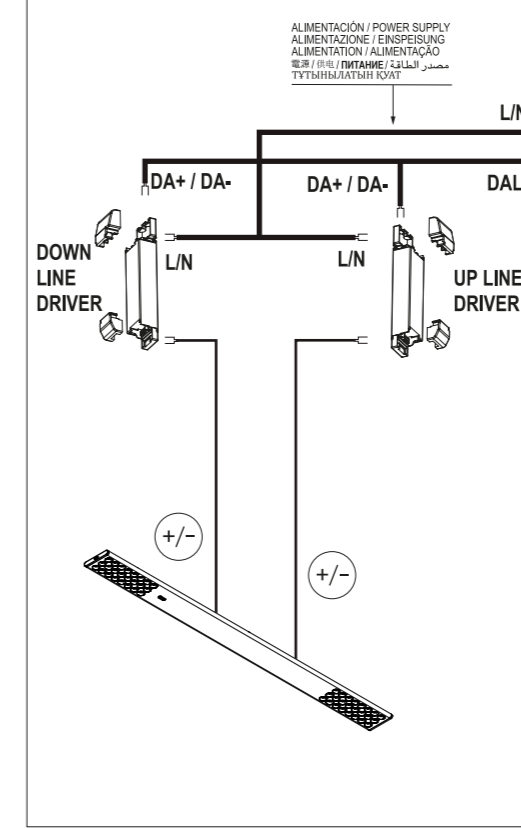

UP&DOWN TW DALI

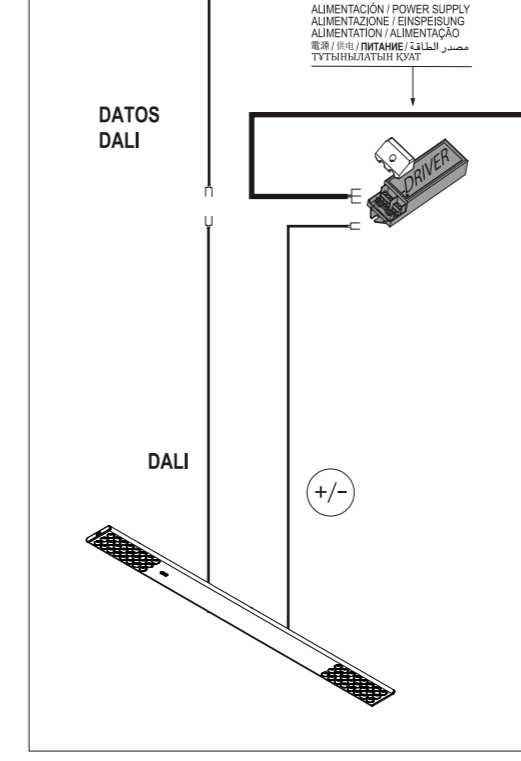

LED DRIVER ≤ 60 Vout

ATTENTION / ATENCIÓN

The voltage under load does not exceed 25 V r.m.s. or 60 V ripple-free d.c. and the no-load voltage does not exceed 35 V peak or 60 V ripple-free d.c. La tensión bajo carga no supera los 25 V r.m.s. o 60 V sin ondulaciones d.c. y la sin carga el voltaje no excede los 35 V pico o 60 V sin ondulaciones d.c.

	Replaceable (LED only) light source by a professional / Fuente de luz (solo LED) reemplazable por un profesional
	Replaceable control gear by professional / Equipo de control reemplazable por profesional

CLASIFICACION ENERGÉTICA		
ENERGY CLASSIFICATION		
DOWN	3000K	C
	3500K	D
	4000K	B
UP	3000K	C
	3500K	
	4000K	
TW		C